





Marcon is continuing to make great strides in the museum and heritage sector, adding to its growing reputation as a specialist fit-out partner in this niche market. It has been a busy 12 months for the Marcon heritage team, completing a number of projects for existing and new clients alike. The company has also been awarded a number of high profile museum and exhibition fit-outs that will run throughout 2015.

Our specialist joinery manufacturing facility played an integral role with the production and installation of bespoke items for all of the above heritage projects.

Front Cover Image

Working with Tandem Design and a range of heritage specialists, we have helped create an interactive exhibition titled 'A Port that Built A City', to mark Belfast Harbour's 400 year old anniversary.

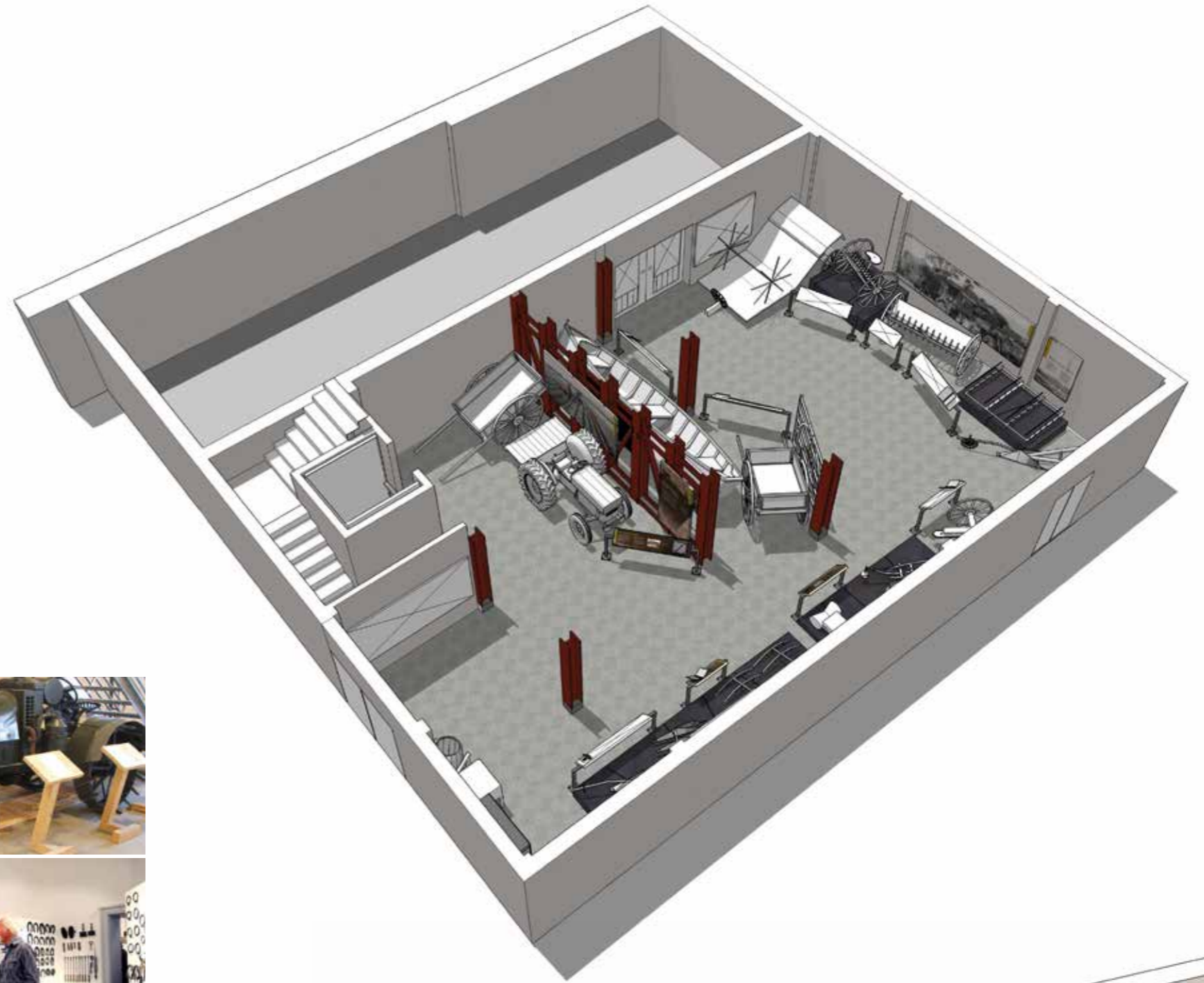

Down County Museum

During the summer, Marcon will be busy fitting out Down County Museum in Downpatrick. The project contains all of the elements of a modern museum fit-out, from display cases, graphics, interactives, models, AV hardware and software. The centre attraction in the museum will be the Downpatrick High Cross. The famous cross which stood at Down Cathedral has been dismantled and a replica put in its place.

The original cross is now on loan to the museum in order to protect it from further deterioration and will be the centre-piece of a new display entitled 'Raising the Cross in Down'. The museum will house the cross, together with new galleries showcasing the Museum's farming artefacts, maritime collection and the story of the gaol.





Gobbins Cliff Path

A new visitor centre at the iconic Gobbins coastal path in Islandmagee, Co. Antrim has utilised the skills and workmanship of Marcon. The new centre at the restored cliff-hanging tourist attraction contains an interactive exhibition that tells the story of the famous cliff walk that was initially built in 1902 and the story of how it has been restored to its former glory. The exhibition also provides an insight into the local wildlife that populates the rugged Co. Antrim coastline.

Marcon Fit-Out was the main contractor for the fit-out of the new exhibition within the Visitors Centre which consisted of set works manufacture and installation, graphics, interactives, AV hardware and AV software. The AV package included audio players, audio handsets, touchscreens, TVs, HD Video servers, tablets, LED projectors, high performance loudspeakers, 6 channel sync audio replay units and amplifiers. Marcon also coordinated the software, video and environmental soundscape package.

Navan Fort

Marcon has been appointed to fit-out a new attraction at Navan Fort, one of the great royal sites of pre-Christian Gaelic Ireland. The historic monument is one of the country's most significant archaeological treasures and is a popular attraction for tourists and school groups.

The new attraction consists of a new internal and external archaeological play area. The new space will contain many physical interactives, puzzles, obstacles, trivia flaps and an ultra violet fossil hunt.

Marcon will utilise its specialist joinery workshop to manufacture and install the set works that will house the interactives, graphics and audio visual elements.



Carrickfergus Castle

This Spring Marcon will be adding the finishing touches to a temporary structure within Carrickfergus Castle. The famous Norman castle which was built in 1177 and is situated on the northern shore of Belfast Lough is one of the best preserved medieval structures in Northern Ireland.

Marcon has been tasked with the manufacture and installation of a moveable exhibition that will form the centre piece to the new space within the castle walls.

Manufactured from plexwood, the plinths will house a medieval themed interactive display that will be used to compare life from the Middle Ages and the present day. The exhibition will contain interactives and puzzles and will be used by school groups and other visitors to the castle.



Titanic Belfast® Gallery Refresh

Titanic Belfast® has embarked upon a gallery refurbishment programme and has entrusted Marcon with this intricate project. Ireland's most visited tourist attraction is remodelling galleries 3, 5a and 5b which will add to the award winning venue.

Working closely with museum designers StudioMB, Marcon has enhanced the space with new interactives, animations, graphics, and specialist joinery items such as a floating table circa 1912 and authentic seating from the era.

Gallery 5b is a replica of the Titanic deck and required the formation of a deck side typical cabin. The cabin allows visitors to see 'Pepper's ghost' which appears as a hologram within the Palm Court Dining Room and also to look out over the view from the deck with an animated projection of the Atlantic Ocean.

Titanic Belfast® has continued to invest in the galleries to ensure that the venue keeps adding to its offer for tourists and repeat visitors. The work to the 3 galleries follows on from the enhancements made to Gallery 2, which contains the now famous 'Shipyard Ride' and the inclusion of the new Ocean Exploration Centre. All of which have been fitted out by Marcon.

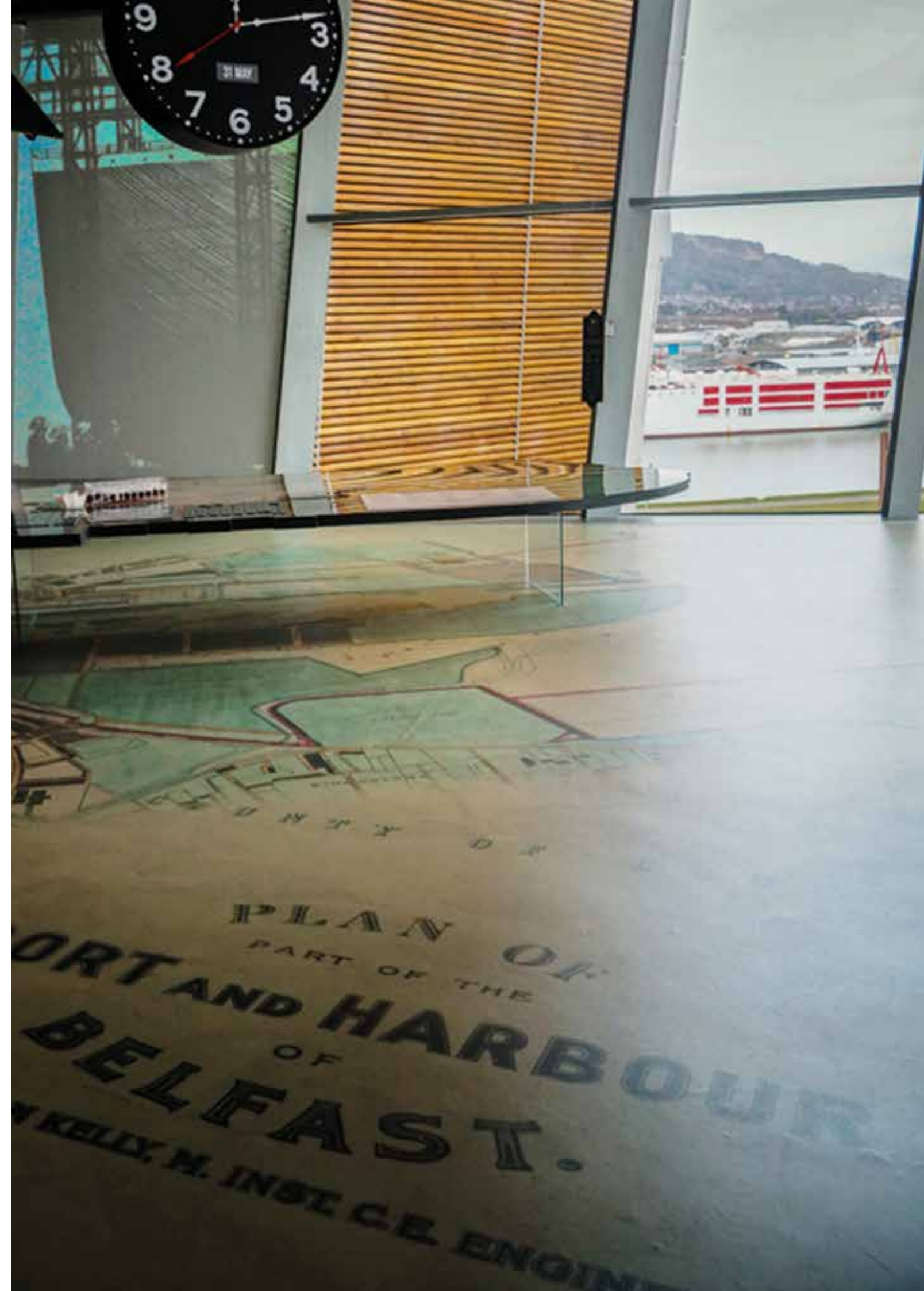



Marcon Fit-Out
A2 Fergusons Way
Kilbegs Road, Antrim
BT41 4LZ

Tel: 028 9446 1222
Fax: 028 9446 4333
hello@marconfitout.com
www.marconfitout.com